

Fill the container with warm water if possible.
Cold water is ok too.

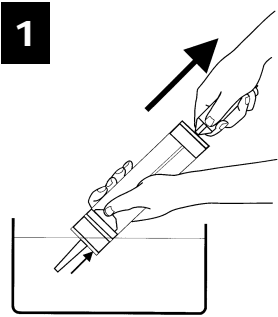

With the Piston Pump :

Dip the pump as illustrated making sure the intake valve (arrow) is under the surface of the water. Then pull back on the handle to draw the water into the pump. The ideal amount of water is approximately 1-1/2 oz (45 ml)



With the Rubber Hand Pump :

Dip the short end into the water. Fill the pump with water until the water squirts out the top.

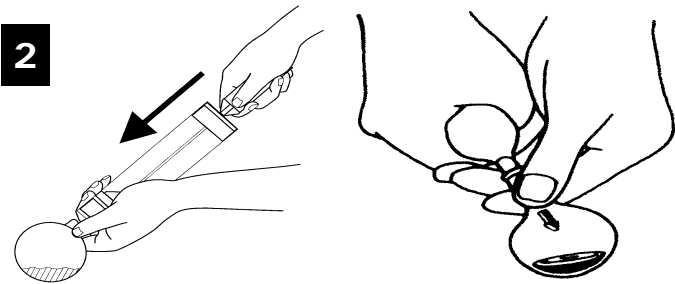

Insert the nozzle into the balloon, so that tip is in the center of the balloon. Hold it securely with one hand. Push water into balloon and continue to pump air into balloon until it is 3" (80 mm), the size of baseball. Wetting the balloon is better for insertion.

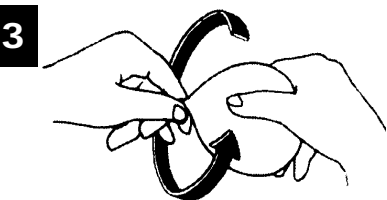

Hold the neck of the balloon securely with one hand and twist 2 ~ 3 times with other hand. This will insure a tight seal.

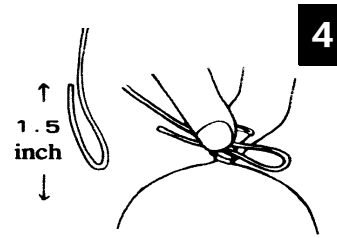

Fold a rubber string as illustrated and hold it together with the neck of the twisted balloon.

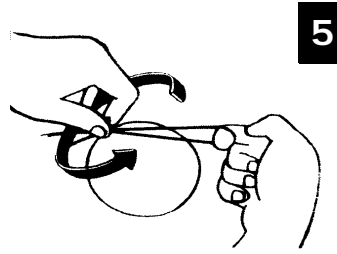

Wrap the loop around the neck 4 to 5 times. Care should be taken not to untwist the twisted balloon.

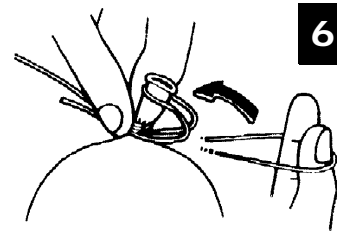

Stretch the loop over the neck of the balloon and hang on the neck.

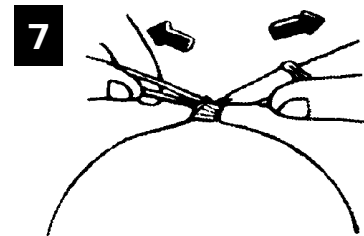

Pull apart rubber string and neck of the balloon to close it.

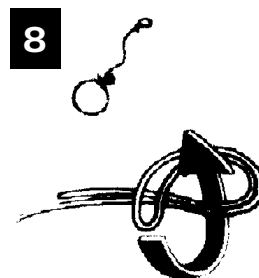

Make another loop at the opposite end of the string.

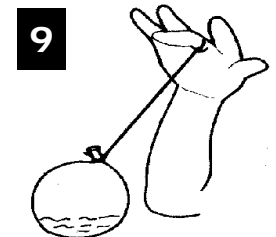

All set to go !